

通过ISO9001:2000质量管理体系认证

通过ISO/TS16949:2002质量管理体系认证



峰成三复 *cnsanfu*

目录 CONTENTS

一 金属塑料复合系列自润滑轴承

Plastic-metallic composite self-lubricating bearings

SF-10 碳钢基自润滑轴承	03
Carbon Steel self-lubricating bearing	
SF-11 碳钢基无铅自润滑轴承	03
Carbon Steel Pb-free self-lubricating bearing	
SF-12 铜基无铅自润滑轴承	04
Bronze Pb-free self-lubricating bearing	
SF-13 不锈钢基自润滑轴承	04
Stainless steel self-lubricating bearing	
SF-14 碳钢基自润滑轴承 (齿轮泵)	05
Carbon Steel self-lubricating bearing (Gear pump)	
SF-15 碳钢基无铅自润滑轴承 (减震器)	05
Carbon Steel Pb-free self-lubricating bearing (absorber)	
SF-16 碳钢基自润滑轴承 (液压泵)	06
Carbon Steel self-lubricating bearing (hydraulic pump)	
SF-17 不锈钢基无铅自润滑轴承	06
Stainless steel Pb-free self-lubricating bearing	
SF-FR 铜网无铅自润滑轴承	07
Bronze mesh Pb-free self-lubricating bearing	
SF-TEX 碳钢基PTFE织物无铅自润滑轴承	07
Carbon steel PTFE fabric Pb-free self-lubricating bearing	
SF-10/11/12/13/14/15/16/17 标准公制轴套公差表	08
Metric Standard Bushing Tolerances Table	
SF-1□ 可供标准产品的标注方式	08
Standard Bushing Label Mode	
SF-10/11/12/13/14/15/16/17 标准公制直套规格表	09
Metric Standard Bushing	
SF-10F/11F/12F/13F/14F/15F/16F 标准公制翻边轴套规格表	11
Metric Standard Flange Bushing	
SF-10W/11W/12W/13W/14W/15W/16W/17W 标准公制垫片规格表	12
Metric Standard Washer	
SF-10P/11P/12P/13P/14P/15P/16P/17P 标准公制滑板规格表	12
Metric Standard Strip	
SF-10/11/12/13/14/15/16/17 标准英制直套规格表	13
Inch Standard Cylindrical Bushing	
SF-10W/11W/12W/13W/14W/15W/16W/17W 标准英制垫片规格表	15
Inch Standard Washer	
SF-20 碳钢基边界无铅自润滑轴承 (黑色)	16
Marginal Pb-free self-lubricating bearing	
SF-21 碳钢基边界无铅自润滑轴承 (中黄色)	16
Marginal Pb-free self-lubricating bearing	
SF-22 碳钢基边界无铅自润滑轴承 (桔红色)	17
Marginal Pb-free self-lubricating bearing	
SF-23 碳钢基边界无铅自润滑轴承 (淡黄色)	17
Marginal Pb-free self-lubricating bearing	
SF-20/21/22/23/ 标准公制轴套公差表	18
Metric Standard Bushing Tolerances Table	
SF-2□ 可供标准产品的标注方式	18
Standard Bushing Label Mode	
SF-20/21/22/23/ 标准公制轴承规格表	19
Metric Standard Bushing	
SF-20W/21W/22W/23W 标准公制垫片规格表	21
Metric Standard Washer	
SF-20P/21P/22P/23P 标准公制滑板规格表	21
Metric Standard Strip	
SF-20/21/22/23 标准英制轴套规格表	22
Inch Standard Cylindrical Bushing	

二 双金属系列自润滑轴承

Bimetallic self-lubricating Bearings

SF-30/31/32/33/34 双金属自润滑轴承	24
Bimetallic self-lubricating bearing	
SF-35 双金属固体自润滑轴承	25
Bimetallic solid self-lubricating bearing	
SF-30/31/32/33/35 标准公制轴套公差表	26
Metric Standard Bushing Tolerances Table	
SF-30/31/32/33/35 双金属自润滑轴套的油槽油穴形式	26
Types for Bi-Metallic Bushing Grooves and Indents	
SF-30/31/32/33/35 双金属自润滑轴套的搭扣形式	26
Lock Types for Bi-Metallic Bushing	
SF-30/31/32/33/35 标准公制轴套规格表	27
Metric Standard Bushing	
SF-80/81/82 金属基弥散型自润滑轴承	28
Metal base point-lubricating bearing	
SF-80/81/82 金属基弥散型自润滑轴承公差表	29
Metal base point-lubricating bearing Tolerances Table	
SF-80/81/82 金属基弥散型自润滑轴承规格表	30
Metal base point-lubricating bearing	

三 单金属系列自润滑轴承

Monometallic self-lubricating Bearings

SF-40 青铜自润滑轴承	31
Bronze self-lubricating bearing	
SF-41 青铜冲孔自润滑轴承	31
Bronze self-lubricating bearing with through holes	
SF-42 青铜固体自润滑轴承	32
Bronze solid self-lubricating bearing	
SF-42 青铜固体自润滑轴承油穴类型	32
Bronze solid self-lubricating bearing Oil pocket Type	
SF-40/41/42 标准公制轴套公差表	33
Metric Standard Bushing Tolerances Table	
SF-4□ 可供标准产品的标注方式	33
Standard Bushing Label Mode	
SF-40/41/42 标准公制轴套规格表	34
Metric Standard Bushing	
SF-40F/41F/42F 标准公制翻边轴套规格表	36
Metric Standard Flange Bushing	
SF-50/51/52/53/54/55 镶嵌式固体润滑轴承	37
Solid-lubricant inlaid bearing	
SF-50 铜基镶嵌式固体润滑轴承规格表	39
Cast Bronze Solid-lubricant bearing with graphites	
SF-50F 铜基翻边镶嵌式固体润滑轴承规格表	41
Cast Bronze flanged solid-lubricant-inlaid bearing	
SF-50W 止推垫片规格表	42
Oilless Thrust Washers	
SF-50SP 滑板规格表	43
Oilless Sliding Plate	
SF-50SL 梯形滑块规格表	44
Echelon sliding liner plate	
SF-50WP 滑块规格表	45
Wear Plate	
SF-54MWP 铸铁滑块规格表	46
Iron Wear Plate	
SF-50MSP 模具滑板规格表	47
Mould Slide Plate	
SF-50PGB 偏法兰模具套套规格表	48
Partial Flange Of Mould Guide Bush	
SF-50MGB 模具导向套规格表	48
Mould Guide Bush	
SF-50CBS 模具导轨规格表	49
CAM Bottom Guide Plate	
SF-70/71/72/73 粉末冶金轴承	50
Powder metallurgy bearing	

四 其它轴承

Other Bearings

SF-60/61/62 直线轴承	51
Retainer bearing	
SF-FD1 含铜四氟轴承	52
Copper PTFE soft strip	
SF-FD2 含石墨四氟轴承	52
Graphite PTFE soft strip	
SF-FD3 改性四氟轴承	52
Modified PTFE soft strip	

五 工艺 品质 其他

Technics Quality Other

卷制轴套的检验方法	53
Method of wrapped bushes measurement	
设计与装配	54
Design and Assemble	
生产工艺流程线	55
Bearing produce line	
与我联系	末页
Contact Us	



SF-10 碳钢基自润滑轴承

Carbon Steel self-lubricating bearing

该产品以优质低碳钢为基体，中间烧结球形青铜层，表面轧制聚四氟乙烯和铅的混合物。它具有较好的自润滑、耐磨损、摩擦系数低、走合性能好、低噪音等性能。产品广泛应用于各种机械的滑动部位，如纺织机、印刷机、液压搬运车、烟草机、健身器、农业机械等。

SF-10 Carbon Steel self-lubricating bearings used high quality low-carbon steel plate as base, sintered porous bronze as its interlayer and the Compound of PTFE and Lead as its surface. It offers the property of good self-lubrication, low wear, low friction, good sliding characteristics, low noise. It has been widely applied to various mechanical sliding positions, such as textile machinery, printing machinery, hydraulic pressure transit vehicle, tobacco machinery, gymnastic instrument and agricultural machinery etc.

※技术参数: Technical Data

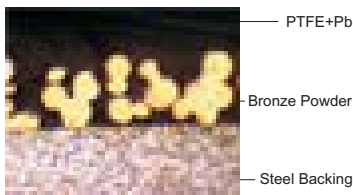

金相组织 (Metallurgical structure)

性能指标 Performance index		数据 Data
最大承载 P Max Load Capacity	静载 Static load	250N/mm ²
	动载 Dynamic load	140N/mm ²
最高线速度 V Max Sliding Speed	干摩擦 Dry friction	2.5m/s
	油润滑 Oil lubrication	5.0m/s
最高 PV 值 Max PV Value Limit	干摩擦 Dry friction	3.6N/mm ² m/s
	油润滑 Oil lubrication	50N/mm ² m/s
摩擦系数 μ Friction coefficient	干摩擦 Dry friction	0.08~0.20
	油润滑 Oil lubrication	0.02~0.07
使用温度 Working temperature		-195℃~+280℃
导热系数 Thermal conductivity		42W/m k
热膨胀系数 Coefficient of thermal expansion		11X10 ⁻⁶ /K

SF-11 碳钢基无铅自润滑轴承

Carbon Steel Pb-free self-lubricating bearing

Lead Free

该产品与SF-10具有相同结构和使用性能，同时它具有环保的特点。产品广泛应用于汽车、食品工业机械、制药机械、饮料机械、医疗设备等绿色工业场合。

Carbon Steel Pb-free self-lubricating bearing which is in the same structure and properties as SF-10. Meanwhile it is characterized by environmental protection. It has been widely applied to automobile, food-processing machinery, pharmacy machinery, beverage machinery, medical equipment etc. On green industry occasions.

※技术参数: Technical Data

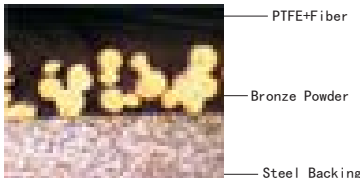

金相组织 (Metallurgical structure)

性能指标 Performance index		数据 Data
最大承载 P Max Load Capacity	静载 Static load	250N/mm ²
	动载 Dynamic load	140N/mm ²
最高线速度 V Max Sliding Speed	干摩擦 Dry friction	2.5m/s
	油润滑 Oil lubrication	5.0m/s
最高 PV 值 Max PV Value Limit	干摩擦 Dry friction	3.6N/mm ² m/s
	油润滑 Oil lubrication	50N/mm ² m/s
摩擦系数 μ Friction coefficient	干摩擦 Dry friction	0.08~0.20
	油润滑 Oil lubrication	0.02~0.07
使用温度 Working temperature		-195℃~+280℃
导热系数 Thermal conductivity		42W/m k
热膨胀系数 Coefficient of thermal expansion		11X10 ⁻⁶ /K



SF-12 铜基无铅自润滑轴承

Bronze Pb-free self-lubricating bearings

Lead Free

该产品以特殊配方铜合金为基体，中间烧结球形青铜层，表面轧制聚四氟乙烯和亲油性纤维的混合物。它具有较好的自润滑、耐磨损、摩擦系数低、耐腐蚀等性能，产品广泛应用于冶金机械、连铸轧机、水泥灌浆机械、螺旋式输送机。

SF-12 Bronze Pb-free self-lubricating bearing used bronze alloy as base with special formulation, sintered porous bronze as its interlayer and the Compound of PTFE and lipophilicity fiber as its surface. It offers the property of good self-lubricating, low wear, low friction, corrosion resistance. It has been widely applied to metallurgy steel machinery, joined casting machinery, cement grout pump and spiral conveyer machinery etc.

※技术参数： Technical Data

性能指标 Performance index		数据 Data
最大承载 P Max Load Capacity	静载 Static load	250N/mm ²
	动载 Dynamic load	140N/mm ²
最高线速度 V Max Sliding Speed	干摩擦 Dry friction	2.5m/s
	油润滑 Oil lubrication	5.0m/s
最高 PV 值 Max PV Value Limit	干摩擦 Dry friction	3.6N/mm ² m/s
	油润滑 Oil lubrication	50N/mm ² m/s
摩擦系数 μ Friction coefficient	干摩擦 Dry friction	0.08~0.20
	油润滑 Oil lubrication	0.02~0.07
使用温度 Working temperature		-195℃~+280℃
导热系数 Thermal conductivity		70W/m k
热膨胀系数 Coefficient of thermal expansion		17X10 ⁻⁶ /K

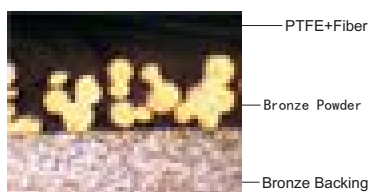

金相组织 (Metallurgical structure)

SF-13 不锈钢基自润滑轴承

Stainless steel self-lubricating bearing

该产品以不锈钢为基体，中间烧结球形青铜层，表面轧制聚四氟乙烯和铅的混合物。它具有较好的自润滑、耐磨损、摩擦系数低、耐腐蚀等性能。产品广泛应用于印染机械、化工机械、海洋工业耐腐蚀部位等。

SF-13 Stainless steel self-lubricating bearing uses stainless steel as base, sintered porous bronze as its interlayer and the Compound of PTFE and Lead as its surface. It offer the property of good self-lubrication, low wear, low friction, corrosion resistance. It has been widely applied to dyeing machinery, chemical engineering machinery and marine industry etc.

※技术参数： Technical Data

性能指标 Performance index		数据 Data
最大承载 P Max Load Capacity	静载 Static load	250N/mm ²
	动载 Dynamic load	140N/mm ²
最高线速度 V Max Sliding Speed	干摩擦 Dry friction	2.0m/s
	油润滑 Oil lubrication	5.0m/s
最高 PV 值 Max PV Value Limit	干摩擦 Dry friction	3.6N/mm ² m/s
	油润滑 Oil lubrication	50N/mm ² m/s
摩擦系数 μ Friction coefficient	干摩擦 Dry friction	0.08~0.20
	油润滑 Oil lubrication	0.02~0.07
使用温度 Working temperature		-195℃~+280℃
导热系数 Thermal conductivity		42W/m k
热膨胀系数 Coefficient of thermal expansion		15X10 ⁻⁶ /K

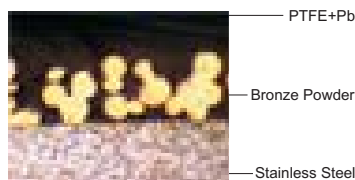

金相组织 (Metallurgical structure)

SF-14 碳钢基自润滑轴承（齿轮油泵）

Carbon Steel self-lubricating bearing (Gear pump)



该产品与SF-10具有相同结构，是齿轮油泵专用轴承。根据齿轮油泵的高PV值条件而设计的特殊配方产品。它具有摩擦系数小而稳定，耐磨性能好，抗冲击的特点，产品广泛应用于齿轮油泵、柱塞泵、叶片泵等。

SF-14 Carbon Steel self-lubricating bearing (Gear pump) has the same structure as SF-10, it is special for gear pump. It is a special formula product devised by high PV value operational mode conditions of gear oil pump. Characterized by low friction factor, stability, well wearing performance and impact resistance, it has been widely applied to gear pumps, radial piston pumps and vane pumps etc.

※技术参数: Technical Data

性能指标 Performance index		数据 Data
最大承载 P Max Load Capacity	静载 Static load	250N/mm ²
	动载 Dynamic load	140N/mm ²
最高线速度 V Max Sliding Speed	干摩擦 Dry friction	2.5m/s
	油润滑 Oil lubrication	5.0m/s
最高 PV 值 Max PV Value Limit	干摩擦 Dry friction	4.3N/mm ² m/s
	油润滑 Oil lubrication	60N/mm ² m/s
摩擦系数 μ Friction coefficient		0.03~0.20
使用温度 Working temperature		-195℃~+280℃
导热系数 Thermal conductivity		42W/m k

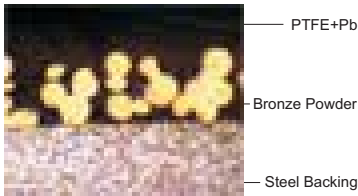

金相组织 (Metallurgical structure)

SF-15 碳钢基无铅自润滑轴承（减震器）

Lead Free

Carbon Steel Pb-free self-lubricating bearing (absorber)



该产品与SF-10具有相同结构，是根据往复运动的特殊工况条件而设计的特殊配方产品，具有断油条件下润滑能力强，耐磨性能好，保持油膜的特点。产品广泛应用于汽车减震器、摩托车减震器、液压马达、气动元

SF-15 Carbon Steel Pb-free self-lubricating bearing has the same structure as SF-10, particularly suitable for intermittent operation, reciprocating or oscillating movements. Characterized by good lubrication and wear performance in the conditions of dry operation of oil. It is applied to shock absorber of automobile, motorcycles and various hydraulic motors and pneumatic elements etc.

※技术参数: Technical Data

性能指标 Performance index		数据 Data
最大承载 P Max Load Capacity	静载 Static load	250N/mm ²
	动载 Dynamic load	140N/mm ²
最高线速度 V Max Sliding Speed	干摩擦 Dry friction	2.5m/s
	油润滑 Oil lubrication	5.0m/s
最高 PV 值 Max PV Value Limit	干摩擦 Dry friction	3.6N/mm ² m/s
	油润滑 Oil lubrication	50N/mm ² m/s
摩擦系数 μ Friction coefficient		0.04~0.20
使用温度 Working temperature		-195℃~+270℃
导热系数 Thermal conductivity		42W/m k

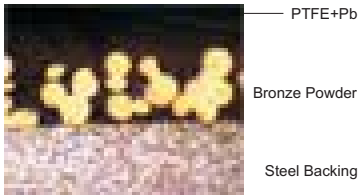

金相组织 (Metallurgical structure)

SF-16 碳钢基自润滑轴承（液压泵）

Carbon Steel self-lubricating bearing (hydraulic pump)

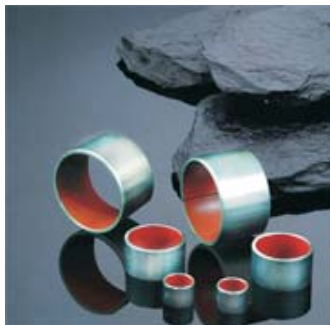

该产品与SF-10具有相同结构，是液压专用轴承，是结合油缸及减震器的工作原理而设计的特殊配方产品。它具有SF-15优点外，特别适用于往复频繁的大侧向力场合，产品适用于汽车减震器、摩托车减震器以及各种液压油缸等。

SF-16 has the same structure with SF-10, particularly suitable for hydraulic pump. It is a special formula designed by combining oil cylinder with the working principle of bumpers. Besides the advantages of SF-15, it is particularly applicable for the situation of great cross range force of frequent to-and-fro. It is applicable for automobile shock absorbers, motorcycle bumper and various hydraulic pressure cylinders etc.

※技术参数：Technical Data

最大承载 P Max Load Capacity	静载 Static load	250N/mm ²
	动载 Dynamic load	140N/mm ²
最高线速度 V Max Sliding Speed	干摩擦 Dry friction	3.0m/s
	油润滑 Oil lubrication	5.0m/s
最高 PV 值 Max PV Value Limit	干摩擦 Dry friction	3.8N/mm ² m/s
	油润滑 Oil lubrication	50N/mm ² m/s
摩擦系数 μ Friction coefficient		0.04~0.20
使用温度 Working temperature		-195℃~+270℃
导热系数 Thermal conductivity		42W/m k

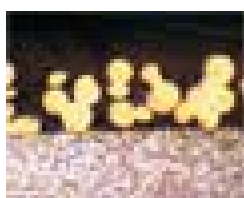

PTFE+Pb
Bronze Powder
Steel Backing

金相组织 (Metallurgical structure)

SF-17 不锈钢基无铅自润滑轴承

Stainless steel Pb-free self-lubricating bearing



该产品以不锈钢为基体，表面涂聚四氟乙烯。它具有较好的耐酸、耐碱、耐海水、环保等特点。产品广泛应用于化工中酸碱流量计、泵、阀以及海洋工业耐腐蚀部位等。

SF-17 Stainless steel Pb-free self-lubricating bearing used stainless steel material as base, spray painting PTFE on the surface. It is characterized by acid-resistant, alkaline-resistant, ocean water resistant and environmental protection. It is used widely as fluid valve of measuring acid and alkalizing flow in chemical industry, and corrosion resisting sliding position in marine industry.

※技术参数：Technical Data

性能指标 Performance index		数据 Data
最大承载 P Max Load Capacity		120N/mm ²
最高线速度 V Max Sliding Speed		2.5m/s
最高 PV 值 Max PV Value Limit	静载 Static load	3.0N/mm ² m/s
	动载 Dynamic load	40N/mm ² m/s
摩擦系数 μ Friction coefficient	干摩擦 Dry friction	0.10~0.25
	油润滑 Oil lubrication	0.05~0.10
使用温度 Working temperature		-195℃~+270℃
导热系数 Thermal conductivity		42W/m k

SF-FR 铜网无铅自润滑轴承

Lead Free

bronze mesh self-lubricating bearing without lead



该产品以青铜丝网为基体，通过特殊工艺，表面轧制聚四氟乙烯和亲油性纤维。它具有较低的摩擦系数、较好的耐磨性以及柔软性好。产品广泛应用于纺织机械关节轴承、汽车门铰链、汽车操纵杆等场合。

SF-FR Bronze Pb-free self-lubricating bearing uses bronze mesh as its structure, by means of special technology, rolled by PTFE at the surface and lipophilicity fiber. It performs well with lower friction and well anti-wear good pliability. It has been widely used in linkage of textile machinery, tailgate hinges, automotive steering and so on.

※技术参数： Technic Data

性能指标 Performance index		数据 Data
最大承载 P Max Load Capacity	静载 Static load	80N/mm ²
	动载 Dynamic load	40N/mm ²
最高线速度 V Max Sliding Speed	干摩擦 Dry friction	1.0m/s
	油润滑 Oil lubrication	2.5m/s
最高 PV 值 Max PV Value Limit		1.65N/mm ² m/s
摩擦系数 μ Friction coefficient		0.05~0.20
使用温度 Working temperature		-40℃~+260℃

SF-TEX 碳钢基PTFE织物无铅自润滑轴承

Lead Free

Carbon steel PTFE fabric Pb-free self-lubricating bearing

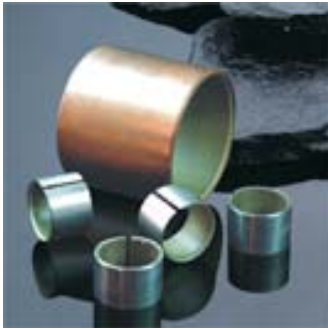

该产品以优质低碳钢为基体，表面覆着以聚四氟乙烯织物。它具有更高承载力、更长的使用寿命。产品广泛应用于农用机械、球阀、蝶阀、水泵以及化工工业等重载低速而无法加油的领域。

SF-TEX is based on steel backing as its structure, the surface is laid with PTFE fabric. It performs well with heavy load and long lifetime. It is widely applies to agriculture machinery, sphere valve, butterfly valve, pumps, chemical industry in the conditions of heavy load, low velocity but unable oiling conditions.

※技术参数： Technic Data

性能指标 Performance index		数据 Data
最大承载 P Max Load Capacity	静载 Static load	350N/mm ²
	动载 Dynamic load	180N/mm ²
最高线速度 V Max Sliding Speed	干摩擦 Dry friction	0.5m/s
	油润滑 Oil lubrication	2.5m/s
最高 PV 值 Max PV Value Limit		3.6N/mm ² m/s
摩擦系数 μ Friction coefficient		0.03~0.20
使用温度 Working temperature		-50℃~+250℃

SF-10/11/12/13/14/15/16/17 标准公制轴套
Metric Standard Bushing

轴套外径公差表

Bushing O.D. Tolerances Table

外径 D Outer Diameter D	外径公差 Outer Diameter Tolerance
$\varnothing D \leq 10$	$+0.055$ $+0.025$
$10 < \varnothing D \leq 18$	$+0.065$ $+0.030$
$18 < \varnothing D \leq 30$	$+0.075$ $+0.035$
$30 < \varnothing D \leq 50$	$+0.085$ $+0.045$
$50 < \varnothing D \leq 80$	$+0.100$ $+0.055$
$80 < \varnothing D \leq 120$	$+0.120$ $+0.070$
$120 < \varnothing D \leq 180$	$+0.170$ $+0.100$
$180 < \varnothing D \leq 250$	$+0.210$ $+0.130$
$250 < \varnothing D \leq 305$	$+0.260$ $+0.170$

轴套壁厚公差

Bushing Wall Thickness Tolerances Table

内径 d Inner Diameter d	壁厚公差 t Wall Thickness Tolerance
$\varnothing d < 5$	$0.75 \begin{smallmatrix} 0 \\ -0.020 \end{smallmatrix}$
$5 \leq \varnothing d \leq 18$	$1.0 \begin{smallmatrix} +0.005 \\ -0.020 \end{smallmatrix}$
$18 < \varnothing d \leq 25$	$1.5 \begin{smallmatrix} +0.005 \\ -0.025 \end{smallmatrix}$
$25 < \varnothing d < 45$	$2.0 \begin{smallmatrix} +0.005 \\ -0.030 \end{smallmatrix}$
$45 \leq \varnothing d < 80$	$2.5 \begin{smallmatrix} +0.005 \\ -0.040 \end{smallmatrix}$
$80 \leq \varnothing d < 120$	$2.5 \begin{smallmatrix} -0.010 \\ -0.060 \end{smallmatrix}$
$\varnothing d \geq 120$	$2.5 \begin{smallmatrix} -0.035 \\ -0.085 \end{smallmatrix}$

可供标准产品的标注方式
Standard Bushing Label Mode

直套标注方式 Bushing Label Mode

SF-1□
直套型号 Bushing Type
直套内径 Bushing Inner Diameter
直套高度 Bushing Length

板材标注方式 Strip Label Mode

SF-1□P
板材型号 Strip Type
板材厚度 Strip Wall Thickness
板材宽度 Strip Width

翻边套标注方式 Flange Bushing Label Mode

SF-1□F
翻边套型号 Flange Bushing Type
翻边套内径 Flange Bushing Inner Diameter
翻边套高度 Flange Bushing Length

垫片标注方式 Washer Label Mode

SF-1□W
垫片型号 Washer Type
垫片规格 Washer Specification

英制直套标注方式 The Inch Bushing Label Mode

SF-1□ DU
直套型号 Bushing Type
直套内径 Bushing Inner Diameter
直套高度 Bushing Length
英制 Inch

英制垫片标注方式 The Inch Washer Label Mode

SF-1□W DU
垫片型号 Washer Type
英制 Inch
垫片规格 Washer Specification

SF-10/11/12/13/14/15/16/17 标准公制直套
Metric Standard Bushing

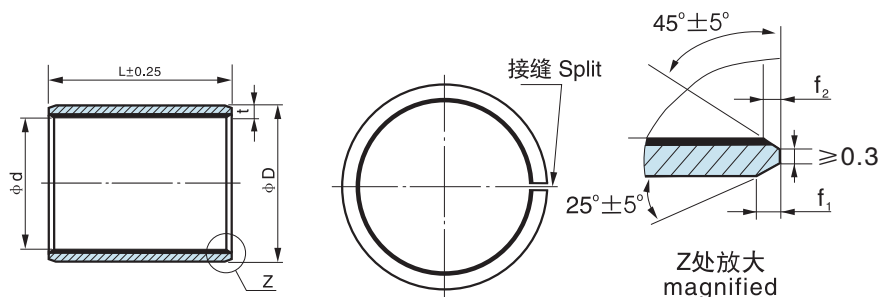

※标准直套标注方式: Standard Bushing Label Mode SF-1□ 0408

单位Unit: mm

型号 Type	外径 D	内径 d	相配轴径 Axle	相配座孔 Housing	f1	f2	L 0.25						
							8	10	15	20	25	30	40
SF-1□	5.5	4	4 ⁰ _{-0.008}	5.5 ^{+0.008} ₀	0.4	0.3	0408	0410					
SF-1□	7	5	5 ^{-0.010} _{-0.022}	7 ^{+0.015} ₀			0508	0510					
SF-1□	8	6	6 ^{-0.010} _{-0.022}	8 ^{+0.015} ₀			0608	0610	0615				
SF-1□	10	8	8 ^{-0.013} _{-0.028}	10 ^{+0.015} ₀			0808	0810	0815				
SF-1□	12	10	10 ^{-0.013} _{-0.028}	12 ^{+0.018} ₀			1008	1010	1015	1020			
SF-1□	14	12	12 ^{-0.016} _{-0.034}	14 ^{+0.018} ₀			1208	1210	1215	1220			
SF-1□	15	13	13 ^{-0.016} _{-0.034}	15 ^{+0.018} ₀	0.6	0.3		1310	1315	1320			
SF-1□	16	14	14 ^{-0.016} _{-0.034}	16 ^{+0.018} ₀				1410	1415	1420			
SF-1□	17	15	15 ^{-0.016} _{-0.034}	17 ^{+0.018} ₀				1510	1515	1520	1525		
SF-1□	18	16	16 ^{-0.016} _{-0.034}	18 ^{+0.018} ₀					1615	1620	1625		
SF-1□	19	17	17 ^{-0.016} _{-0.034}	19 ^{+0.021} ₀					1715	1720	1725		
SF-1□	20	18	18 ^{-0.016} _{-0.034}	20 ^{+0.021} ₀					1815	1820	1825		
SF-1□	23	20	20 ^{-0.020} _{-0.041}	23 ^{+0.021} ₀					2015	2020	2025	2030	
SF-1□	25	22	22 ^{-0.020} _{-0.041}	25 ^{+0.021} ₀	0.8	0.4				2220	2225	2230	
SF-1□	27	24	24 ^{-0.020} _{-0.041}	27 ^{+0.021} ₀						2420	2425	2430	
SF-1□	28	25	25 ^{-0.020} _{-0.041}	28 ^{+0.021} ₀						2520	2525	2530	2540
SF-1□	32	28	28 ^{-0.020} _{-0.041}	32 ^{+0.025} ₀						2820	2825	2830	2840
SF-1□	34	30	30 ^{-0.020} _{-0.041}	34 ^{+0.025} ₀						3020	3025	3030	3040
SF-1□	36	32	32 ^{-0.025} _{-0.050}	36 ^{+0.025} ₀	1.2	0.6				3220	3225	3230	3240
SF-1□	39	35	35 ^{-0.025} _{-0.050}	39 ^{+0.025} ₀						3520	3525	3530	3540
SF-1□	42	38	38 ^{-0.025} _{-0.050}	42 ^{+0.025} ₀						3820	3825	3830	3840
SF-1□	44	40	40 ^{-0.025} _{-0.050}	44 ^{+0.025} ₀						4020	4025	4030	4040
SF-1□	50	45	45 ^{-0.025} _{-0.050}	50 ^{+0.025} ₀						4520	4525	4530	4540
SF-1□	55	50	50 ^{-0.025} _{-0.050}	55 ^{+0.030} ₀	1.6	0.8						5030	5040
SF-1□	60	55	55 ^{-0.030} _{-0.060}	60 ^{+0.030} ₀								5530	5540

SF-10/11/12/13/14/15/16/17 标准公制直套
Metric Standard Bushing

型号 Type	外径 D	内径 d	相配 轴径 Axle	相配 座孔 Housing	f1	f2	L 0.25					
							40	50	60	70	80	100
SF-1□	65	60	60 ^{-0.030} _{-0.060}	65 ^{+0.030} ₀	1.6	0.8	6040	6050	6060			
SF-1□	70	65	65 ^{-0.030} _{-0.060}	70 ^{+0.030} ₀			6540	6550	6560			
SF-1□	75	70	70 ^{-0.030} _{-0.060}	75 ^{+0.030} ₀			7040	7050	7060	7070		
SF-1□	80	75	75 ^{-0.030} _{-0.060}	80 ^{+0.030} ₀				7550	7560	7570		
SF-1□	85	80	80 ⁰ _{-0.045}	85 ^{+0.035} ₀			8040	8050	8060	8070		
SF-1□	90	85	85 ⁰ _{-0.054}	90 ^{+0.035} ₀				8550	8560	8570	8580	
SF-1□	95	90	90 ⁰ _{-0.054}	95 ^{+0.035} ₀				9050	9060	9070	9080	
SF-1□	100	95	95 ⁰ _{-0.054}	100 ^{+0.035} ₀				9550	9560	9570	9580	
SF-1□	105	100	100 ⁰ _{-0.054}	105 ^{+0.035} ₀				10050	10060	10070	10080	
SF-1□	110	105	105 ⁰ _{-0.054}	110 ^{+0.035} ₀				10550	10560	10570	10580	
SF-1□	115	110	110 ⁰ _{-0.054}	115 ^{+0.035} ₀				11050	11060	11070	11080	
SF-1□	120	115	115 ⁰ _{-0.054}	120 ^{+0.035} ₀				11550	11560	11570	11580	
SF-1□	125	120	120 ⁰ _{-0.054}	125 ^{+0.040} ₀					12060	12070	12080	
SF-1□	130	125	125 ⁰ _{-0.063}	130 ^{+0.040} ₀					12560	12570	12580	
SF-1□	135	130	130 ⁰ _{-0.063}	135 ^{+0.040} ₀					13060	13070	13080	
SF-1□	140	135	135 ⁰ _{-0.063}	140 ^{+0.040} ₀					13560	13570	13580	
SF-1□	145	140	140 ⁰ _{-0.063}	145 ^{+0.040} ₀					14060	14070	14080	
SF-1□	150	145	145 ⁰ _{-0.063}	150 ^{+0.040} ₀					14560	14570	14580	
SF-1□	155	150	150 ⁰ _{-0.063}	155 ^{+0.040} ₀					15060	15070	15080	
SF-1□	160	155	155 ⁰ _{-0.063}	160 ^{+0.040} ₀					15560	15570	15580	
SF-1□	165	160	160 ⁰ _{-0.063}	165 ^{+0.040} ₀					16060	16070	16080	160100
SF-1□	180	175	175 ⁰ _{-0.063}	180 ^{+0.040} ₀						17570	17580	175100
SF-1□	190	185	185 ⁰ _{-0.072}	190 ^{+0.046} ₀						18570	18580	185100
SF-1□	200	195	195 ⁰ _{-0.072}	200 ^{+0.046} ₀						19570	19580	195100
SF-1□	210	205	205 ⁰ _{-0.072}	210 ^{+0.046} ₀						20570	20580	205100
SF-1□	220	215	215 ⁰ _{-0.072}	220 ^{+0.046} ₀						21570	21580	215100
SF-1□	230	225	225 ⁰ _{-0.072}	230 ^{+0.046} ₀							22580	225100
SF-1□	240	235	235 ⁰ _{-0.072}	240 ^{+0.046} ₀							23580	235100
SF-1□	250	245	245 ⁰ _{-0.072}	250 ^{+0.046} ₀							24580	245100
SF-1□	260	255	255 ⁰ _{-0.081}	260 ^{+0.052} ₀							25580	255100
SF-1□	280	275	275 ⁰ _{-0.081}	280 ^{+0.052} ₀							27580	275100
SF-1□	305	300	300 ⁰ _{-0.081}	305 ^{+0.052} ₀							30080	300100

SF-10F/11F/12F/14F/15F/16F 标准公制翻边轴承

Metric Standard Flange Bushing

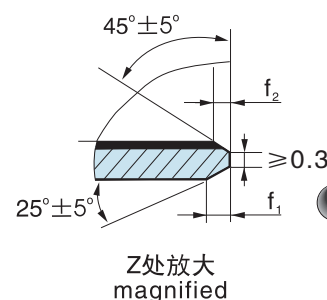
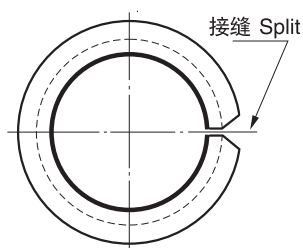
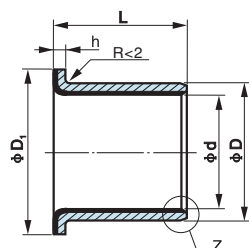

※标准翻边套标注方式: Standard Flange Bushing Label Mode SF-1□F 06040

单位Unit: mm

型号规格 Designation	内径 Ø d	外径 Ø D	法兰外径 Ø D ₁ 0.5	法兰壁厚 h ⁰ _{-0.20}	高度 L 0.25	f1	f2	相配轴径 Axle	相配座孔 Housing
SF-1□F 06040	6	8	12	1.0	4	0.6	0.3	6 ^{-0.010} _{-0.022}	8 ^{+0.015} ₀
SF-1□F 06070					7				
SF-1□F 08055	8	10	15		5.5			8 ^{-0.013} _{-0.028}	10 ^{+0.015} ₀
SF-1□F 08075					7.5				
SF-1□F 10070	10	12	18		7			10 ^{-0.013} _{-0.028}	12 ^{+0.018} ₀
SF-1□F 10090					9				
SF-1□F 10120					12				
SF-1□F 12070	12	14	20		7			12 ^{-0.016} _{-0.034}	14 ^{+0.018} ₀
SF-1□F 12090					9				
SF-1□F 12120					12				
SF-1□F 14120	14	16	22		12			14 ^{-0.016} _{-0.034}	16 ^{+0.018} ₀
SF-1□F 14170					17				
SF-1□F 15090	15	17	23		9			15 ^{-0.016} _{-0.034}	17 ^{+0.018} ₀
SF-1□F 15120					12				
SF-1□F 15170					17				
SF-1□F 16120	16	18	24		12			16 ^{-0.016} _{-0.034}	18 ^{+0.018} ₀
SF-1□F 16170					17				
SF-1□F 18120	18	20	26		12			18 ^{-0.016} _{-0.034}	20 ^{+0.021} ₀
SF-1□F 18170					17				
SF-1□F 18200					20				
SF-1□F 20115	20	23	30	1.5	11.5	0.8	0.4	20 ^{-0.020} _{-0.041}	23 ^{+0.021} ₀
SF-1□F 20165					16.5				
SF-1□F 20215					21.5				
SF-1□F 22150	22	25	32		15			22 ^{-0.020} _{-0.041}	25 ^{+0.021} ₀
SF-1□F 22200					20				
SF-1□F 25115	25	28	35		11.5			25 ^{-0.020} _{-0.041}	28 ^{+0.021} ₀
SF-1□F 25165					16.5				
SF-1□F 25215					21.5				
SF-1□F 30160	30	34	42	2.0	16	1.2	0.6	30 ^{-0.020} _{-0.041}	34 ^{+0.025} ₀
SF-1□F 30260					26				
SF-1□F 35160	35	39	47		16			35 ^{-0.025} _{-0.050}	39 ^{+0.025} ₀
SF-1□F 35260					26				
SF-1□F 40260	40	44	53		26			40 ^{-0.025} _{-0.050}	44 ^{+0.025} ₀
SF-1□F 40400					40				

SF-10W/11W/12W/13W/14W/15W/16W/17W

标准公制垫片

Metric Standard Washer

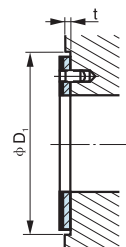
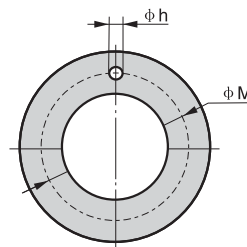
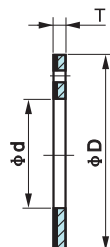

※标准垫片标注方式: Standard Washer Label Mode SF-1□W10

单位Unit: mm

相配轴径 Axle	型号规格 Designation	垫片尺寸 Washer Dimension				安装尺寸 Installation Size			
		D ⁰ _{-0.25}	d ^{+0.25} ₀	T ⁰ _{-0.050}	ØM 0.125	h ^{+0.40} _{+0.10}	t 0.20	D ₁ ^{+0.12} ₀	
8	SF-1□W10	20	10	1.5	15	1.5	1.0	20	
10	SF-1□W12	24	12		18			24	
12	SF-1□W14	26	14		20	2.0		26	
14	SF-1□W16	30	16		23			30	
16	SF-1□W18	32	18		25	32			
18	SF-1□W20	36	20		28	3.0		36	
20	SF-1□W22	38	22		30			38	
22	SF-1□W24	42	24		33			42	
24	SF-1□W26	44	26		35			44	
26	SF-1□W28	48	28		38	4.0		48	
30	SF-1□W32	54	32	43	54				
36	SF-1□W38	62	38	50	62				
40	SF-1□W42	66	42	54	66				
46	SF-1□W48	74	48	61	1.5		74		
50	SF-1□W52	78	52	65			78		
60	SF-1□W62	90	62	76		90			

SF-10P/11P/12P/13P/14P/15P/16P/17P 标准公制滑板

Metric Standard Strip

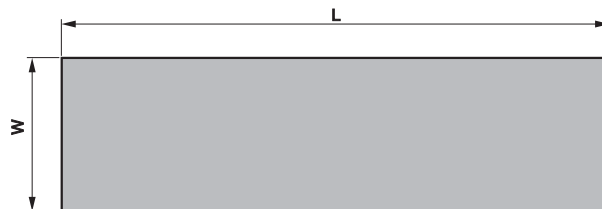
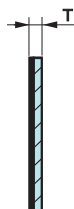

※标准板材标注方式: Standard Strip Label Mode SF-1□P 010130

单位Unit: mm

型号规格 Designation	长度 Length $L \begin{smallmatrix} +5.0 \\ 0 \end{smallmatrix}$	宽度 Width $W \begin{smallmatrix} +2.0 \\ 0 \end{smallmatrix}$	厚度 Thickness $T \begin{smallmatrix} 0 \\ -0.050 \end{smallmatrix}$
SF-1□P 010130	500	130	1.0
SF-1□P 015130	500	130	1.5
SF-1□P 020130	500	130	2.0
SF-1□P 025130	500	130	2.5

SF-10/11/12/13/14/15/16/17 英制标准直套
Inch Standard Cylindrical Bushes

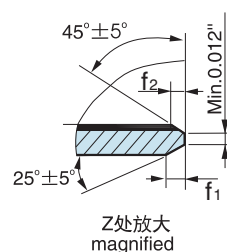
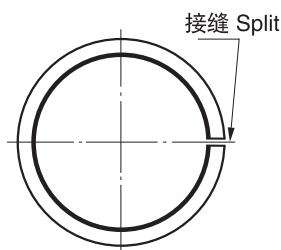
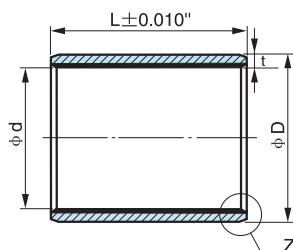

※标准英制直套标注方式: Standard Inch Bushing Label Mode SF-1 □ 02DU02

单位Unit: inch"

型号规格 Designation	公称尺寸 Nominal Diameter			壁厚 Bush Wall t	相配轴径 Axle	相配座孔 Housing	安装后内孔 Installed I.D	f1	f2
	d	D	L						
SF-1 □ 02DU02	1/8	3/16	1/8	0.0315 0.0305	0.1243	0.1878	0.1268	0.008 0.024	0.004 0.012
SF-1 □ 02DU03			3/16		0.1236	0.1873	0.1243		
SF-1 □ 03DU03	3/16	1/4	3/16		0.1865	0.2503	0.1893		
SF-1 □ 03DU04			1/4		0.1858	0.2497	0.1867		
SF-1 □ 03DU06			3/8						
SF-1 □ 04DU04	1/4	5/16	1/4		0.2490	0.3128	0.2518		
SF-1 □ 04DU06			3/8		0.2481	0.3122	0.2492		
SF-1 □ 05DU06	5/16	3/8	3/8		0.3115	0.3753	0.3143		
SF-1 □ 05DU08			1/2		0.3106	0.3747	0.3117		
SF-1 □ 06DU06	3/8	15/32	3/8	0.0471 0.0461	0.3740	0.4691	0.3769	0.020 0.040	0.005 0.025
SF-1 □ 06DU08			1/2		0.3731	0.4684	0.3742		
SF-1 □ 06DU12			3/4						
SF-1 □ 07DU08	7/16	17/32	1/2		0.4365	0.5316	0.4394		
SF-1 □ 07DU12			3/4		0.4355	0.5309	0.4367		
SF-1 □ 08DU08	1/2	19/32	1/2		0.4990	0.5941	0.5019		
SF-1 □ 08DU10			5/8		0.4980	0.5934	0.4992		
SF-1 □ 08DU14			7/8						
SF-1 □ 09DU08	9/16	21/32	1/2	0.0627 0.0615	0.5615	0.6566	0.5644	0.020 0.040	0.005 0.025
SF-1 □ 09DU12			3/4		0.5605	0.6559	0.5617		
SF-1 □ 10DU08	5/8	23/32	1/2		0.6240	0.7192	0.6270		
SF-1 □ 10DU10			5/8		0.6230	0.7184	0.6242		
SF-1 □ 10DU12			3/4						
SF-1 □ 12DU08	3/4	7/8	1/2		0.7491	0.8755	0.7525		
SF-1 □ 12DU12			3/4		0.7479	0.8747	0.7493		
SF-1 □ 12DU16			1						
SF-1 □ 14DU12	7/8	1	3/4		0.8741	1.0005	0.8775		
SF-1 □ 14DU16			1		0.8729	0.9997	0.8743		

SF-10/11/12/13/14/15/16/17

英制标准直套

Inch Standard Cylindrical Bushes

型号规格 Designation	公称尺寸 Nominal Diameter			壁厚 Bush Wall t	相配轴径 Axle	相配座孔 Housing	安装后内孔 Installed I.D	f1	f2
	d	D	L						
SF-1□ 16DU12	1	9/8	3/4	0.0627	0.9991	1.1256	1.0026	0.020 0.040	0.005 0.025
SF-1□ 16DU16			1	0.0615	0.9979	1.1246	0.9992		
SF-1□ 18DU12	9/8	41/32	3/4	0.0784 0.0770	1.1238	1.2818	1.1278		
SF-1□ 18DU16			1		1.1226	1.2808	1.1240		
SF-1□ 20DU12	5/4	45/32	3/4		1.2488	1.4068	1.2528		
SF-1□ 20DU16			1		1.2472	1.4058	1.2490		
SF-1□ 20DU20			5/4						
SF-1□ 22DU16	11/8	49/32	1		1.3738	1.5318	1.3778		
SF-1□ 22DU22			11/8		1.3722	1.5308	1.3740		
SF-1□ 24DU16	3/2	53/32	1		1.4988	1.6568	1.5028		
SF-1□ 24DU24			3/2		1.4972	1.6558	1.4990		
SF-1□ 24DU32			2						
SF-1□ 26DU16	13/8	57/32	1		1.6238	1.7818	1.6278		
SF-1□ 26DU24			3/2		1.6222	1.7808	1.6240		
SF-1□ 28DU16	7/4	31/16	1	0.0941 0.0923	1.7487	1.9381	1.7535		
SF-1□ 28DU28			7/4		1.7471	1.9371	1.7489		
SF-1□ 28DU32			2						
SF-1□ 30DU16	15/8	33/16	1		1.8737	2.0633	1.8787		
SF-1□ 30DU30			15/8		1.8721	2.0621	1.8739		
SF-1□ 30DU36			9/4						
SF-1□ 32DU16	2	35/16	1		1.9987	2.1883	2.0037		
SF-1□ 32DU32			2		1.9969	2.1871	1.9989		
SF-1□ 32DU40			5/2						
SF-1□ 36DU32	9/4	39/16	2	0.0928 0.0902	2.2507	2.4377	2.2573		
SF-1□ 36DU36			9/4		2.2489	2.4365	2.2509		
SF-1□ 36DU48			3						
SF-1□ 40DU32	5/2	43/16	2		2.5011	2.6881	2.5077		
SF-1□ 40DU48			3		2.4993	2.6869	2.5013		
SF-1□ 44DU32	11/4	47/16	2		2.7500	2.9370	2.7566		
SF-1□ 44DU48			3		2.7482	2.9358	2.7502		
SF-1□ 48DU32	3	51/16	5/2		3.0000	3.1872	3.0068		
SF-1□ 48DU48			3		2.9982	3.1858	3.0002		
SF-1□ 48DU60			15/4						
SF-1□ 64DU48	4	67/16	3		4.0000	4.1872	4.0068		
SF-1□ 64DU60			15/4		3.9978	4.1858	4.0002		
SF-1□ 64DU76			19/4						

SF-10W/11W/12W/13W/14W/15W/16W/17W

标准英制垫片

Inch Standard Washer

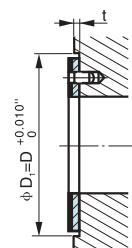
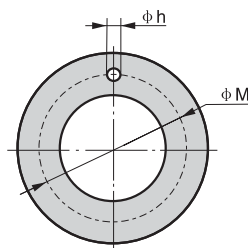
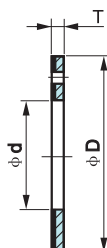

※标准英制垫片标注方式: Standard Inch Washer Label Mode SF-1□W D

单位Unit: inch"

型号规格 Designation	垫片尺寸 Washer Dimension				安装尺寸 Installation Size		
	D ⁰ _{-0.010}	d ^{+0.010} ₀	T ⁰ _{-0.002}	M ^{+0.010} ₀	h ^{+0.010} ₀	t ^{+0.010} ₀	D _i ^{+0.010} ₀
SF-1□W DU06	0.875	0.500	0.063	0.682	0.067	0.040	0.875
SF-1□W DU07	1.000	0.562		0.776			1.000
SF-1□W DU08	1.125	0.625		0.870	1.125		
SF-1□W DU09	1.187	0.687		0.932	1.187		
SF-1□W DU10	1.250	0.750		0.995	1.250		
SF-1□W DU11	1.375	0.812		1.089	1.375		
SF-1□W DU12	1.500	0.875		1.182	1.500		
SF-1□W DU14	1.750	1.000		1.370	1.750		
SF-1□W DU16	2.000	1.125		1.557	2.000		
SF-1□W DU18	2.125	1.250		1.682	2.125		
SF-1□W DU20	2.250	1.375		1.807	2.250		
SF-1□W DU22	2.500	1.500		1.995	2.500		
SF-1□W DU24	2.625	1.625		2.120	2.625		
SF-1□W DU26	2.750	1.750		2.245	2.750		
SF-1□W DU28	3.000	2.000	0.093	2.495	0.070	3.000	
SF-1□W DU30	3.125	2.215		2.620		3.125	
SF-1□W DU32	3.250	2.250		2.745		3.250	